

FORM NO. 1.

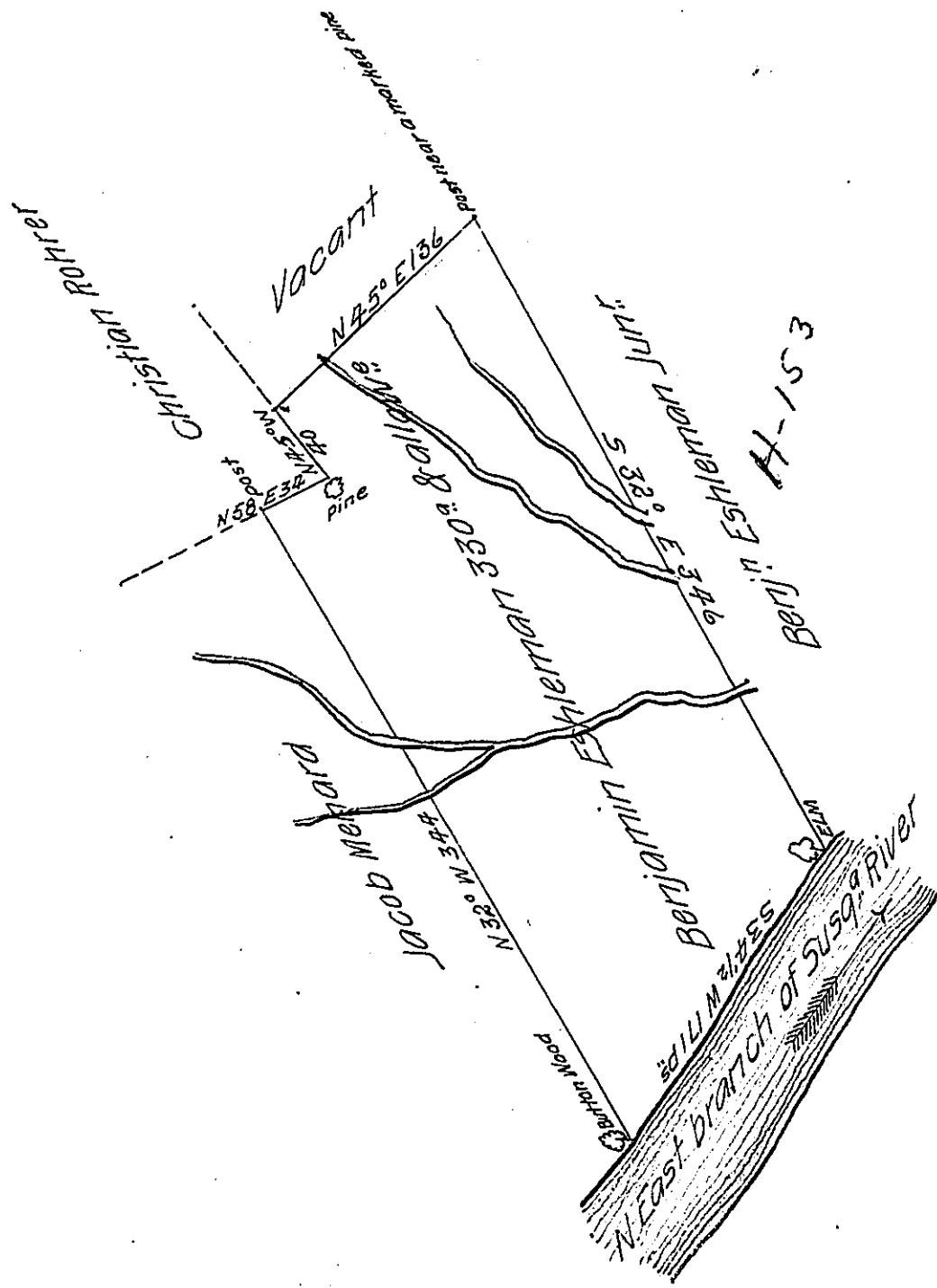

A draught of a tract of land called — situate on the east side of the north east branch of Susquehanna river and between the mouth of Wesaughking and Minarie — in the County of Northumberland adjoining and below land surveyed for Jacob Menard containing three hundred and thirty acres besides the usual allowance of 6 P cent for roads & ^{tr} surveyed the 27th day of September 1773 in pursuance of an order to Benjamin Estleman dated the 3^d day of April 1769 Number 1480

To John Lukens Esq^r
Survey^r Gen^l

by Chas Stewart Dep^t Sur^v

IN TESTIMONY that the above is a copy of the original remaining on file in the Department of Internal Affairs of Pennsylvania, made conformably to an Act of Assembly approved the 16th day of February 1833, I have hereunto set my hand and caused the Seal of said Department to be affixed at Harrisburg, this nineteenth day of March 1907

Isaac R. Brown
Secretary of Internal Affairs.